

Hydrotech 89 Valve Softener Quick Set Up Manual

Step 1 – Inspection

Check to make sure you got everything supplied by factory and there is no visible or concealed damage. In case of missing items, please contact customer service immediately and have the Product Serial # handy. (Product Serial # can be found at the back of the control valve, see below)

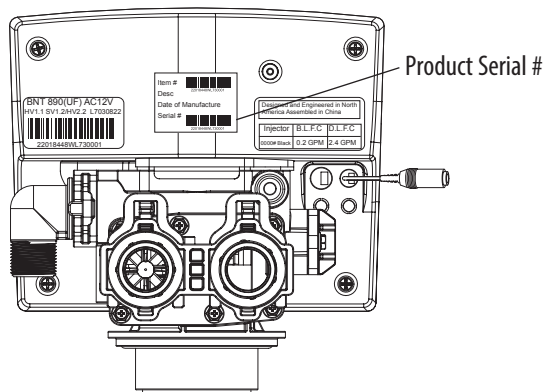

The items you will expect are:

1. Tank with Media loaded
2. Control Valve
3. Parts Kit
4. Brine Tank (Round or Square) and Components

1. Tank with Media loaded

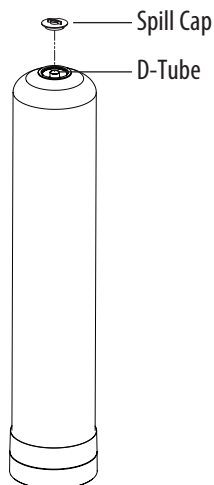

2. Control Valve

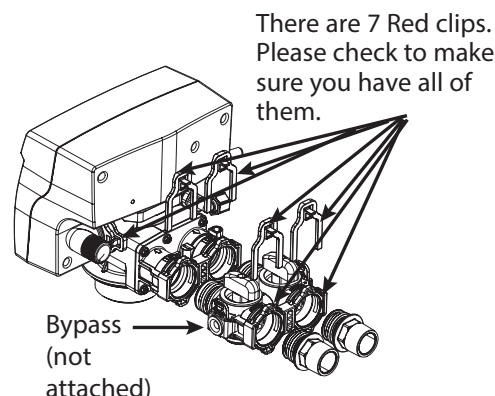

3. Parts Kit

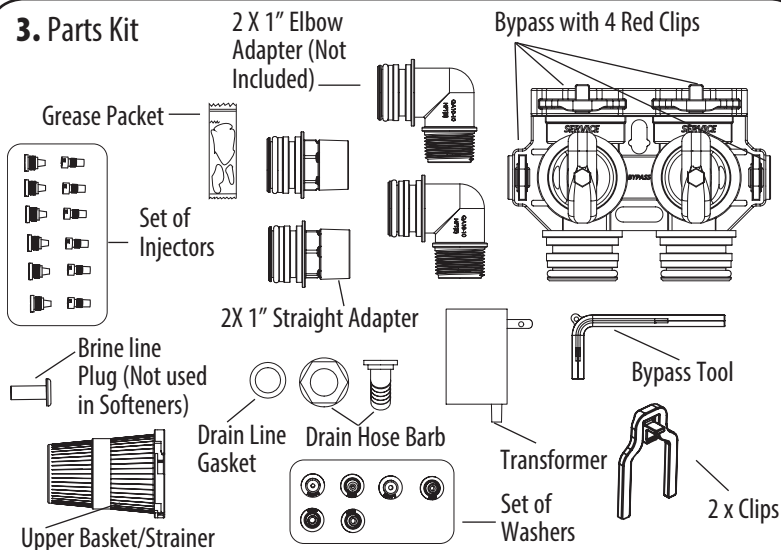

4. Brine Tank (Round or Square) and Components

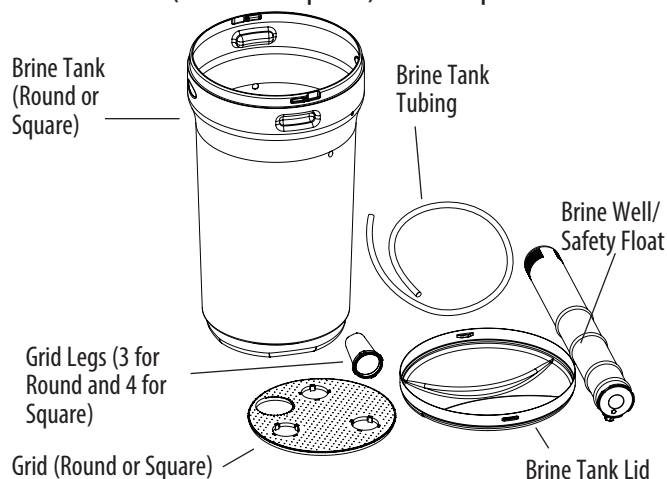

Step 2 – Installing Valve to the Tank

Select a Installation location and make sure there is access to 110V power outlet and drain line. Lube the bottom Valve Orings with the grease supplied, Attach the Upper Basket. Unscrew the spill cap. Carefully Slide the D-Tube inside the Valve and Screw the Valve inside the Tank such that the power cord doesnt get caught between the valve and the tank

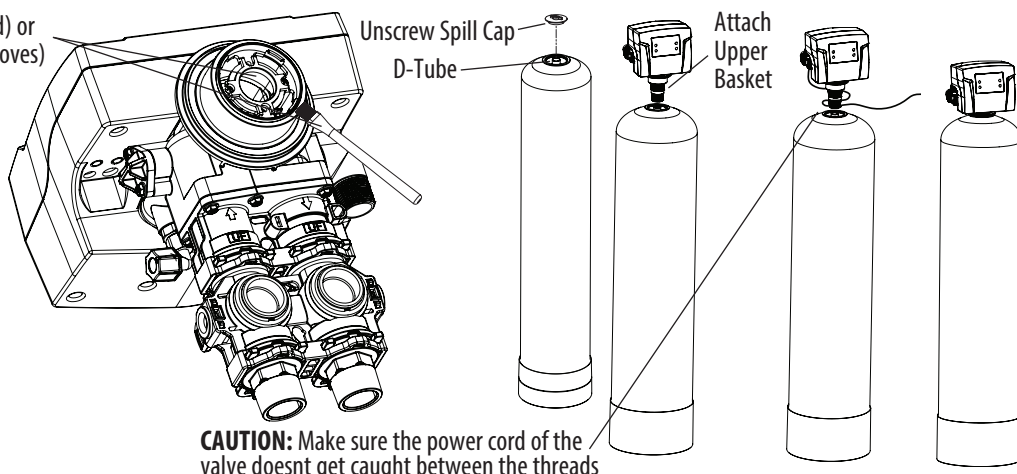

a. Attach the three brine grid legs to grid plate. The legs will snap on to the tabs of the salt plate making a “click” sound. For square brine tank there are four legs.

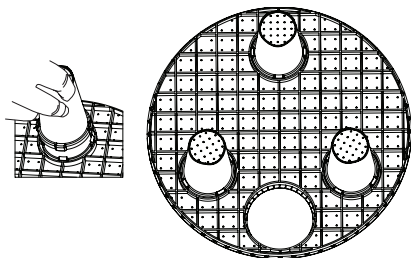

**IMPORTANT: IN
ROUND BRINE TANK,
IT IS IMPORTANT TO
ALIGN THE HANDLE TO
THE BRINE WELL AS
SHOWN**

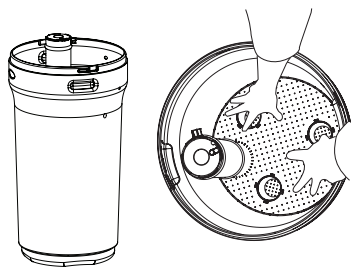

The diagram illustrates the connection of the water filter to the water inlet. On the left, a vertical section shows the filter being inserted into the inlet. On the right, a top-down view of the filter housing shows the internal structure, including a central 'Hole' and a surrounding mesh.

Insert Sleeve

A line drawing showing the base of the blender on the left and the pitcher on the right. A power cord is connected to the base and loops around to plug into the back of the pitcher.

Diagram showing the front view of the engine assembly. The fuel line is connected to the fuel inlet on the right side of the engine block.

Step 5 – Install Drain Line Hose Barb

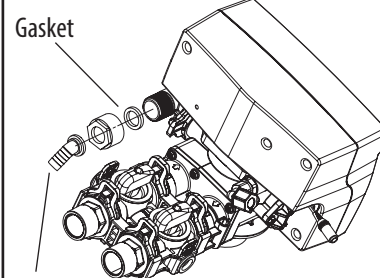

MENU

[MENU](#)



SET

Flow Rate: 24.5 GPM
18-Apr-2015 10:35AM
Remain: 1,280 GAL
Capacity: 1,500 GAL



+



